

LBI-19

sprung lever handle attached to rose
with stainless steel sub-rose
stainless steel

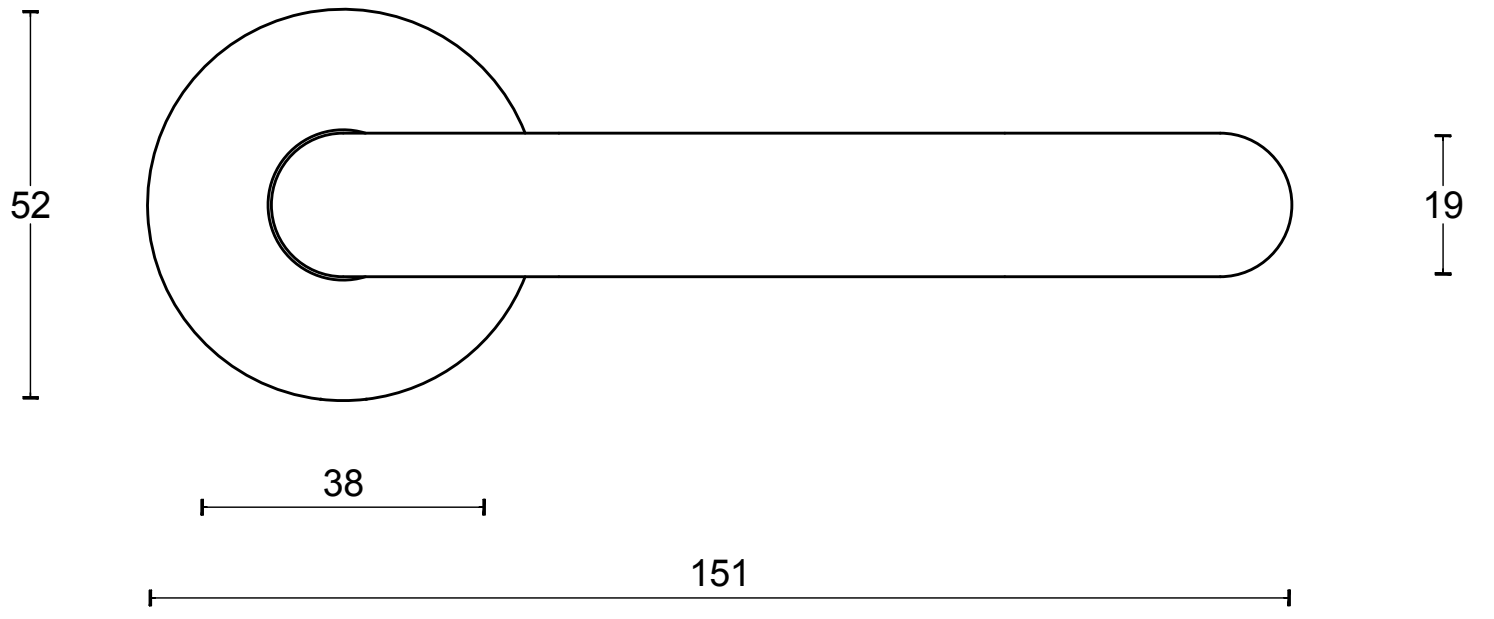
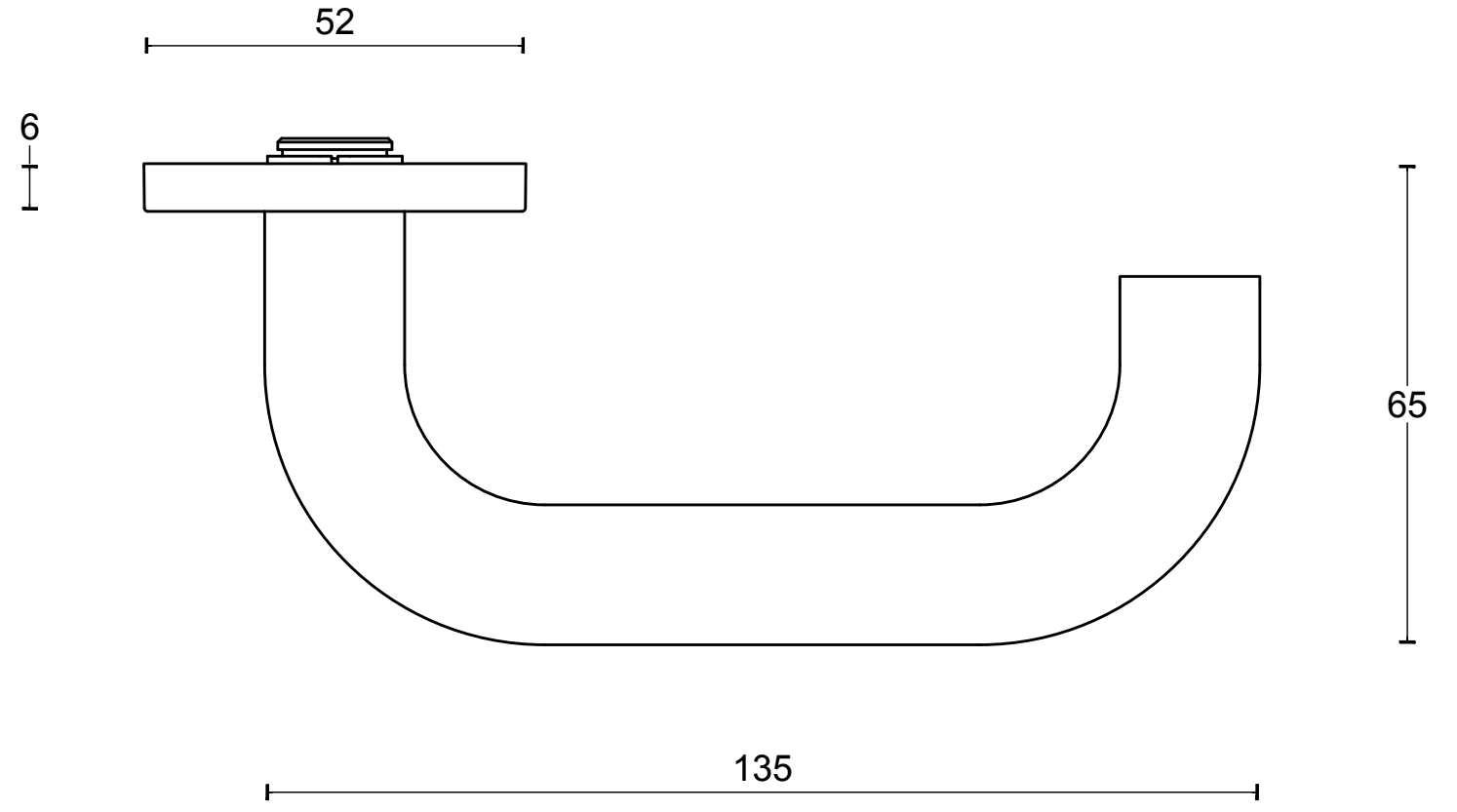
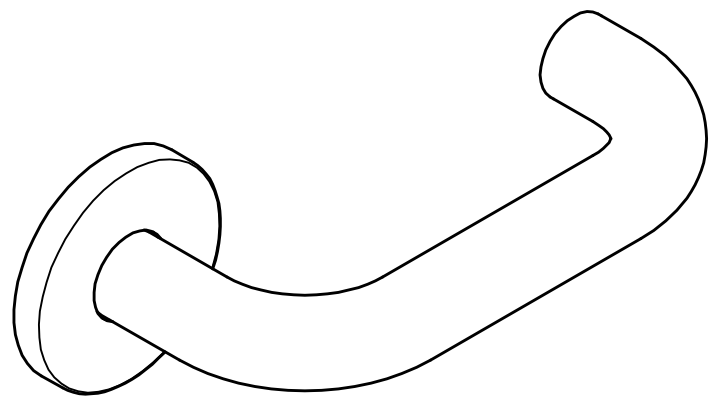
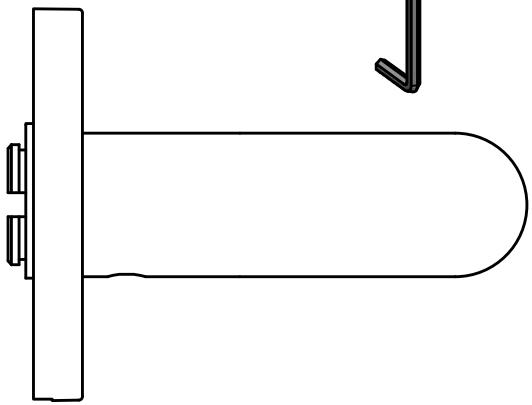
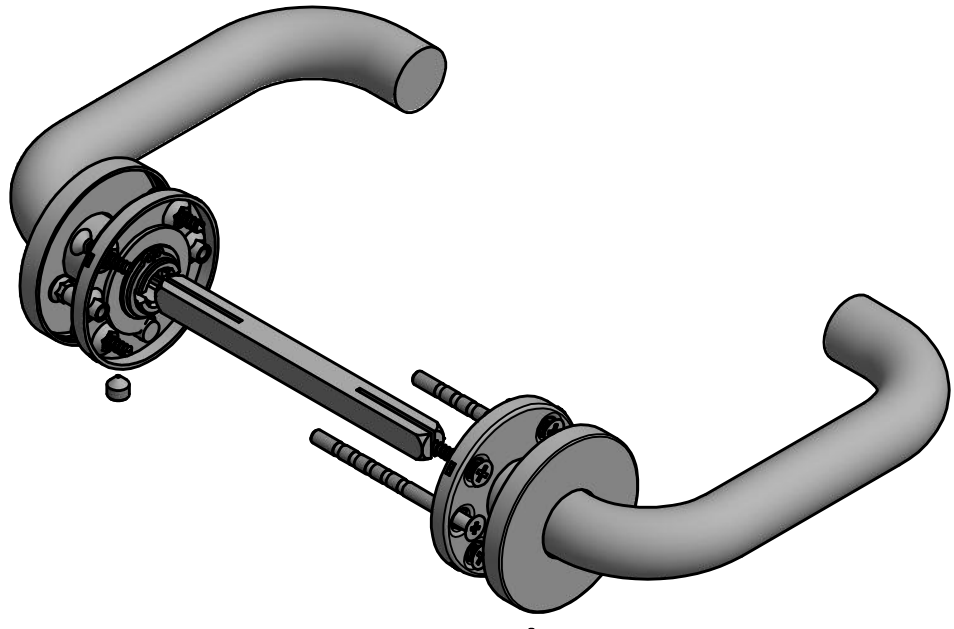

EN 1906: 2012
37-0030B
SKG .0338.8049.ENG
door thickness 38 - 45 mm

FORMANI®		Part number:	
		Description:	
Doc no.:	1501D140 LB-I 19 V01.dwg	LBI-19	Format: A3
Drawn by:	Christian Brimbois		
FORMANI HOLLAND B.V. EUROPALAAN 12 6199 AB MAASTRICHT-AIRPORT NL T +31 (0)43 308 90 00 INFO@FORMANI.COM FORMANI.COM			